



阿伐流体控制有限公司

AFA FLOW CONTROL CO.,LTD

地址：山东省青岛市西海岸新区铁山工业园

邮编：266423

电话：86-532-82123333

传真：86-532-82126600

邮箱：afaxzz@163.com

网址：Http://www.afavalve.com

● 若有改动，恕不通知。请用户使用最新版本，本公司拥有最终解释权
采用生态纸印刷

Expert in Wear-resistant Ball Valves for Harsh Working Conditions



www.afavalve.com

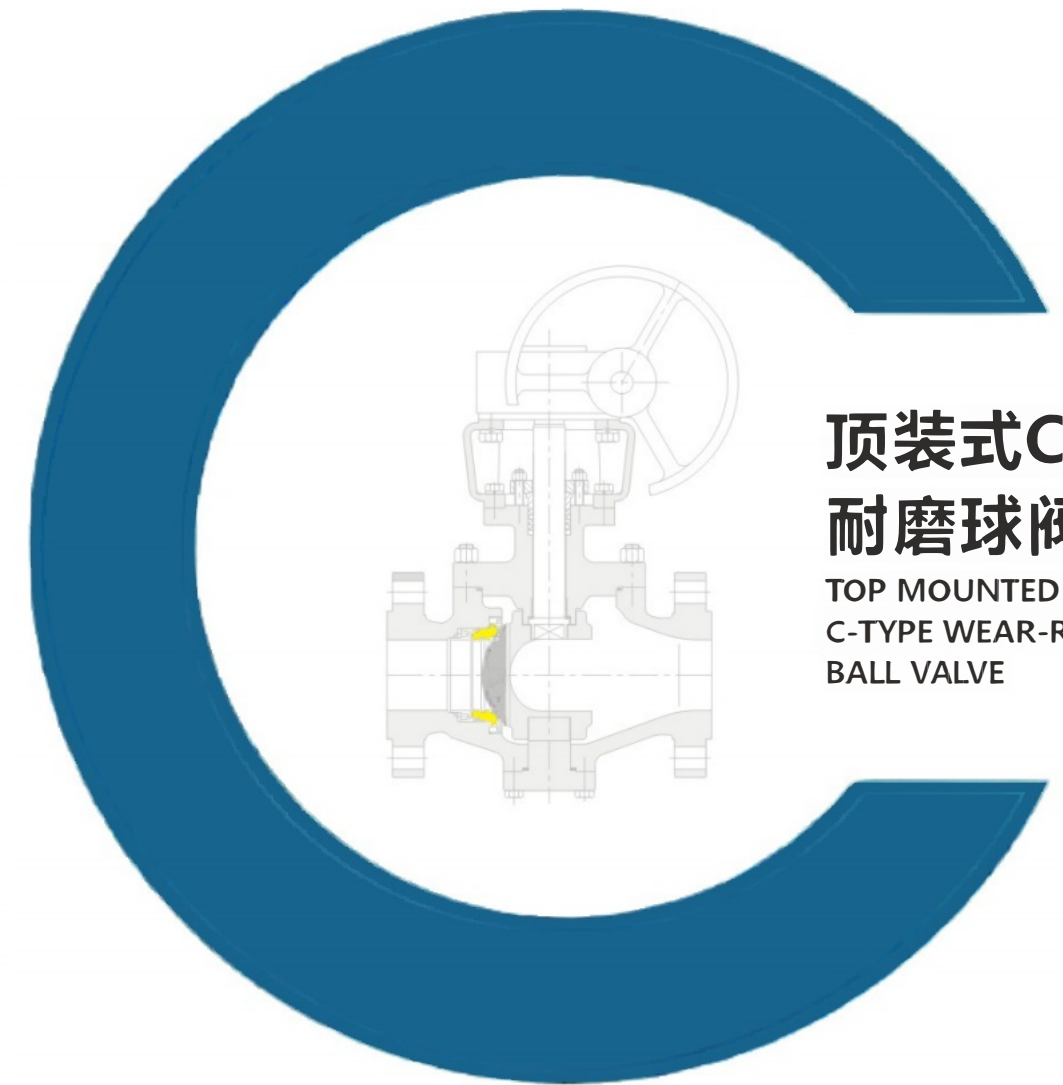

顶装式C型 耐磨球阀

TOP MOUNTED
C-TYPE WEAR-RESISTANT
BALL VALVE

阿伐流体控制有限公司
AFA FLOW CONTROL CO.,LTD



Expert in Wear-resistant Ball Valves for Harsh Working Conditions

Since 2005

COMPANY PROFILE



CONTENT

01~02	COMPANY PROFILE
03~08	CERTIFICATIONS
09~10	INTELLIGENCE MANUFACTURING
11~12	INSPECTION & TESTING
13~14	BOUTIQUE DISPLAY
15~16	APPLICATION AREA
17~19	OVERVIEW OF C-TYPE WEAR-RESISTANT BALL VALVE
20~22	SPECIFICATIONS OF C-TYPE WEAR-RISISITANT BALL VALVE
23	NUMBERING METHOD C-TYPE WEAR-RESISTANT BALL VALVE
24	QUALITY SERVICE COMMITMENT

AFA FLOW CONTROL CO., LTD (AFA for short) is located in Tieshan Industrial Park, West Coast New Area, Qingdao. It covers an area of 25,000 square meters and a building area of 20,000 square meters. We are a technology-based valve company integrating R&D, manufacturing, sales and service. Since its establishment in 2005, the company has focused on the R&D and manufacturing of metal touch wear-resistant ball valves, and has obtained more than 60 patent technologies. Among them, the C-type wear-resistant ball valve is the company's independently developed leading product suitable for harsh working conditions. It has obtained a national invention patent and filled the gap in the domestic market of the same type.

The company's major products include: metal touch ball valve, C-type wear-resistant ball valve, top-mounted C-type wear-resistant ball valve, high-performance multi-eccentric C-type wear-resistant ball valve, high-performance C&V-type regulating ball valve, insulation jacket C-type wear-resistant ball valve and cryogenic ball valve.

The product size range is: 1/2"-60";
pressure level: Class150~Class2500;
temperature range: -196 ~-816 .

We focus on introducing international advanced technology, and adopt production standards: API, ANSI, DIN, BS, JIS, GB and other foreign general standards. Our products are widely used in coal chemical industry, petrochemical industry, offshore platform, LNG, MDI, PTA, POSM, CHPPO, Polycrystalline silicon, air separation, hydrogen peroxide and other industries.

The company attaches great importance to product quality and implements a comprehensive quality management system. The company has obtained TS (A1, B), ISO9001, ISO14001, ISO45001, APIGD, AP1608, APJ607, APIGFA, AP1641, ISO15848, TA-LUFT, SIL3, CE, EAC and other certificates.

We always adhere to the development strategy of "people-oriented, technological innovation, honest management, and brand-based" to serve the society with high-quality products. We are willing to work together with friends from all around the world to create brilliant future together!



QUALIFICATION HONOR

Fine Workmanship, Proven by Certifications. The certifications and honors the company has obtained are a recognition of its past achievements, as well as an encouragement to create brilliance in the future.



Business Licence



Certification of High and New Technology Enterprises



Trademark Registration Certificate Export Enterprise Registration Form



API-608-证书



Certificate of Enterprise Credit Grade



API-6D-证书



TS证书



ISO9001质量体系证书



ISO14001质量体系证书



ISO45001质量体系证书



CE证书



IA-LUP11低泄漏证书



API 64低泄漏证书



ISO15848-1微泄证书



SIL3证书



API607防火证书



API6FA防火证书



知识产权管理体系认证证书

QUALIFICATION HONOR



We use innovative technology to improve the competitiveness of enterprises

Independent innovation has always been the core strategy of the company's development. Since its establishment, the company has always adhered to the product route of independent research and development, relying on a strong R&D team and continuous R&D investment, and has always been at the forefront of industry technology, which provides customers with competitive high-quality products and services.



We advocate learning, unity, competition and creativity



QUALIFICATION HONOR

We use mature technology and reliable product quality to serve users, contribute to society and develop enterprises



INTELLIGENT MANUFACTURING

Large-scale manufacturing builds the strength and brand of an enterprise

The company insists on the path of strengthening the enterprise development with science and technology. In the upstream of the industrial chain, the company is equipped with a professional foundry which has hundreds of high-end intelligent manufacturing equipment to carry out fine processing of products. The company adopts ERP and other production management systems for production and quality management. Through careful operation and lean management, the ability to control product quality throughout the process is guaranteed.

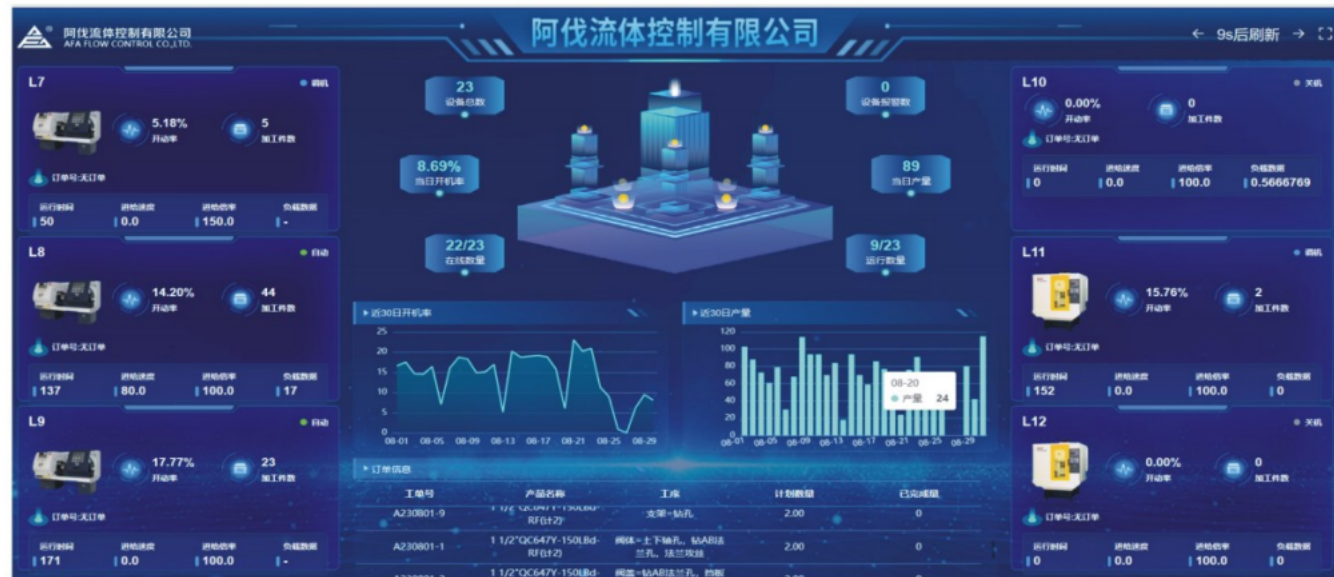

INSPECTION & TESTING

Quality is reflected in unparalleled reliability

The company has a modern quality inspection center and test center, with heat treatment, chemical analysis, spectral analysis, metallurgical analysis, mechanical properties analysis, radiographic testing, ultrasonic flaw detection, ultrasonic flaw detection, magnetic particle flaw detection, large and medium-sized pressure test valve test benches, etc.

We adhere to the quality policy of "take customer as priority, achieving zero customer complaints; system-based, pursuing zero product defects", promote user satisfaction projects, and do our best to meet customer needs and expectations.



Boutique Display

Product components are strictly inspected from material selection, processing, production, assembly and debugging.



Expert in Wear-resistant Bal Valves for Harsh Working Conditions

www.afavalve.com



APPLICATION AREA

Major customers: CNPC, Sinopec, CNOOC, Shenhua, Wanhua, Wison and more than 100 other domestic companies.



Our Strategic Partners



The top-mounted C-type wear-resistant ball valve is a great solution specially developed and designed for harsh working conditions. It combines the functions and advantages of various valves for harsh working conditions and eliminates their design weaknesses and defects. It is suitable for a variety of harsh working conditions such as high pressure, high temperature, low temperature, viscosity, easy scaling and crystallization. It has stable performance and can well replace meta touch ball valves, orbit ball valves, wear-resistant gate valves, open ball valves and other products. It is very suitable for the demanding requirements of key application fields such as coal chemical industry, petrochemical industry, natural gas, chemical industry, petroleum, mining, liquefied natural gas, etc.

Dedicated for Harsh Working Conditions :

- LNG
- PTA、MDI、TDI
- POSM、CHPPO
- Syngas
- Catalyst Particles
- Molecular Sieve, Air Separation
- Petroleum and Natural Gas
- Polysilicon, Silicone
- Black Water, Grey Water, Slag Water
- Coal Slurry, Coal Powder
- Mud, Slurry
- Acetic Acid

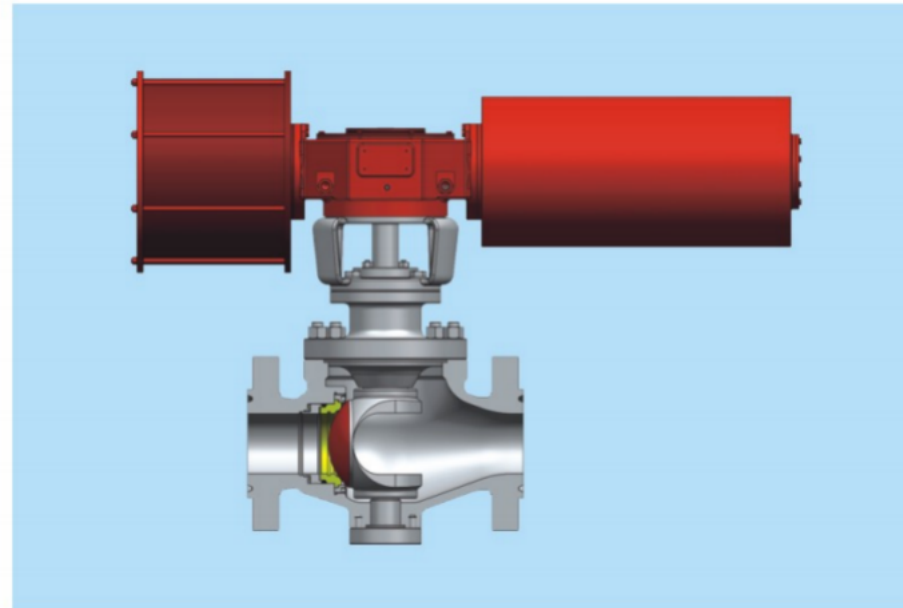

Core Technology Features

- Top-mounted Design Facilitates Timely Valve Maintenance
- Double Eccentric Design, Forced sealing
- The Ball Valve is Designed to be Friction-free and Wear-free When Switching
- Fixed Ball Design
- No Dead Cavity, Fully Opened
- C Ball's Spherical Surface is Fully Coated
- Anti-lock at High Temperatures
- Self-cleaning function

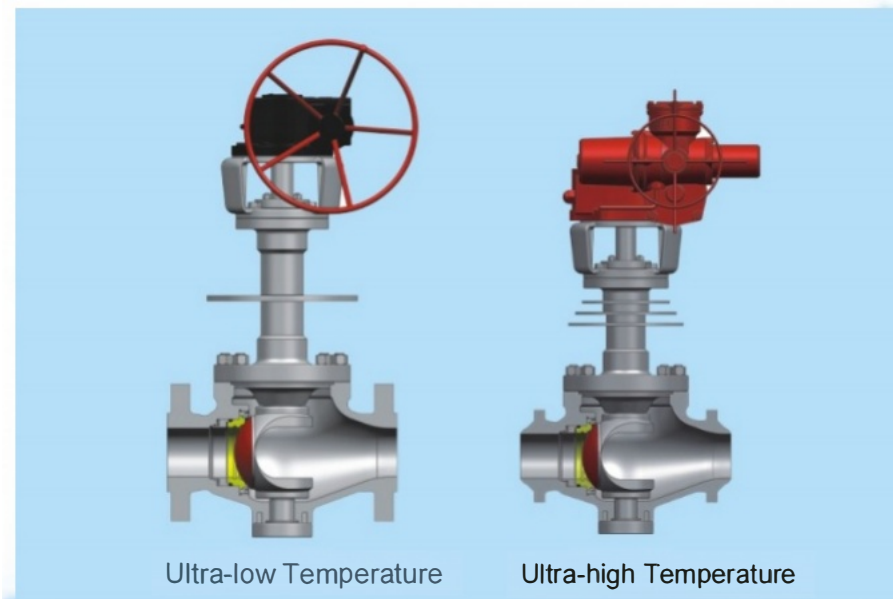

Top-mounted Structure

The valve body is designed in one piece, eliminating the risk of leakage due to pipeline pressure or external torque, and can be maintained in time

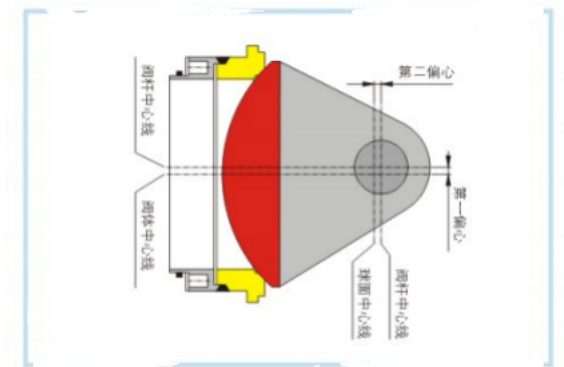

Forced Seal, Low Torque

Double eccentric design, forced sealing. No friction and low torque during the switching process, which can greatly extend the service life of the product.

100% C Ball Surface Hardening

The C ball has a fully hardened coating on the spherical surface, which is resistant to high flow rate, erosion and abrasion. The sealing surface is mainly sprayed with nickel-based alloy, with a hardness of more than HRC60. It can also be sprayed with tungsten carbide, chromium carbide, etc. with higher hardness according to user requirements.

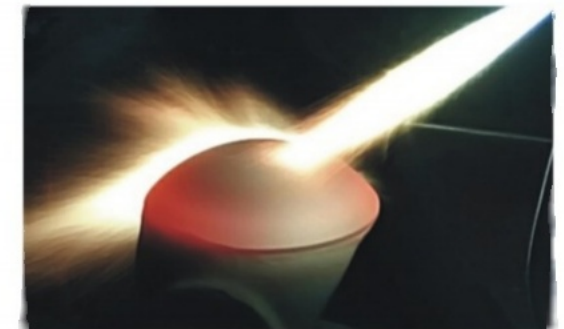

Ultra-high Temperature Design

The unique design can prevent the ball valve from locking when operating at high temperatures. The integral valve body is not affected by high temperatures and prevents leakage of the middle flange seal

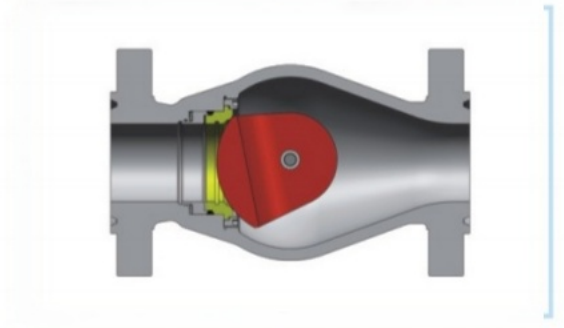

Fixed ball valve

The fixed shaft provides a highly rigid assembly structure, making the ball valve suitable for switching requirements under high pressure differentials.

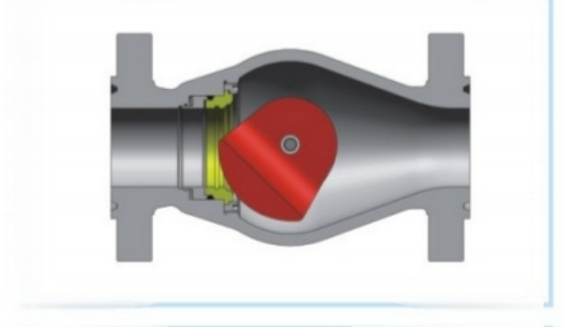

"No Dead Cavity, Fully Opened" Design

The fully opened design without dead cavity inside the ball valve makes it difficult for slag and scaling to accumulate inside the ball valve. The special funnel shaped structure design allows the ball valve to be flushed by fluid to achieve a self-cleaning function.

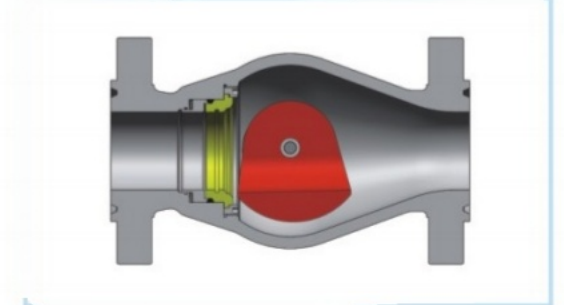

Quick switch

The 1/4 turn travel design allows the ball valve to be opened and closed quickly.

Option

Low Leakage:

Top mounted C-type wear-resistant ball valve can be equipped with low leakage packing to meet the requirements of low leakage working conditions.

Two-way Sealing:

According to customer requirements, the requirements for two-way sealing of ball valves can be met.

Soft Sealing Seat:

Soft sealing valve seat can be selected according to customer requirements.

Operation Method:

Standard worm gear, electric, pneumatic, hydraulic or air motor actuators are available.

Other Adjustment Series:

The product has a variety of configurations to reduce noise, vibration, turbulence, or cavitation. It can be designed according to the customer's working conditions.

Extended Bonnet:

At low temperatures, keep the packing away from cold areas. At high temperatures, make the valve easier to operate.

Valve Sleeve:

When butt welding, you can choose to assemble a welding short pipe to ensure the sealing of the valve at the welding end.

Jacket:

The jacket can be insulated to maintain the fluidity of the medium.

Purge Device:

The valve body can reserve a purge port position, and purge holes can be added as required.

Specifications, Dimensions and Performance

Nominal Diameter: 1" - 60"

Pressure Level: 150LB - 2500LB

Temperature Range: -196°C - +816°C

Standards and Specifications

- Quality Standard: ISO 9001
- Design Standard: ASMEB16.34、API6D、AP1608
- Structure Length: ASMEB16.10
- Inspection Standard: AP1598、ANSIB16.104
- Fire Protection Standard: API607、API6AF
- Low Leakage Standard: ISO 15848
- Connection End Size: ASMEB16.5、ASMEB16.47

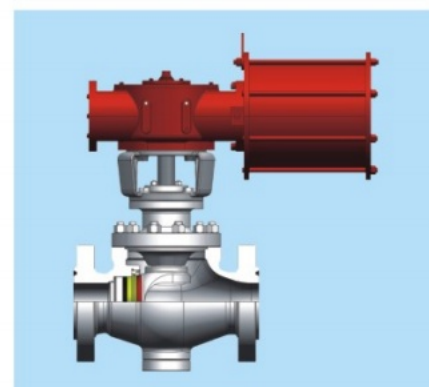
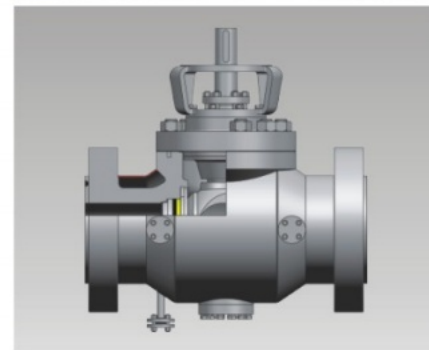
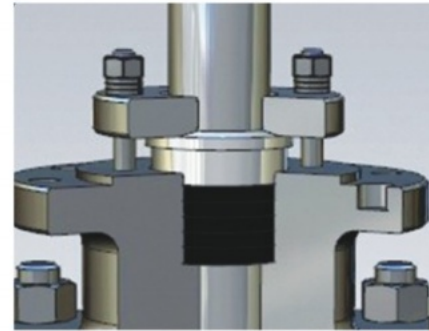

Specifications of Top-mounted C-type Wear-resistant Ball Valve

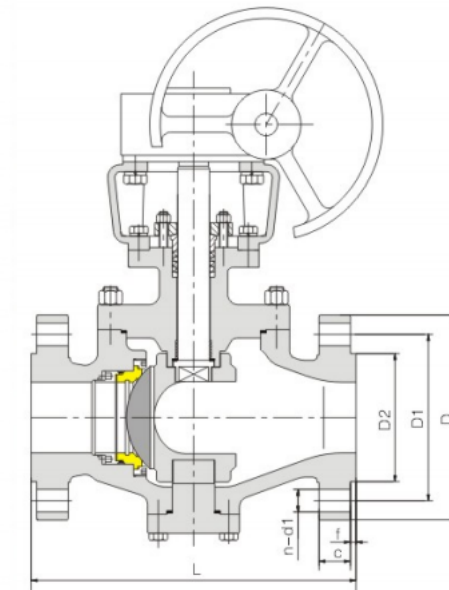

Pressure		Bore		Size								unit: mm
CLASS	Mpa	DN	NPS	L(RF)	L(BW)	D	D1	D2	n-d1	c	f	
150	2.0	25	1	127	165	108	79.2	50.8	4-φ16	9.7	1.5	
		32	1 1/4	140	178	117	88.9	63.5	4-φ16	11.2	1.5	
		40	1 1/2	165	190	127	98.6	73	4-φ16	12.7	1.5	
		50	2	178	216	152	120.6	91.9	4-φ19	14.2	1.5	
		65	2 1/2	191	241	178	139.7	104.6	4-φ19	15.7	1.5	
		80	3	203	283	190	152.4	127	4-φ19	17.5	1.5	
		100	4	229	305	229	190.5	157.2	8-φ19	22.4	1.5	
		125	5	356	381	254	215.9	185.7	8-φ22	22.4	1.5	
		150	6	394	457	279	241.3	215.9	8-φ22	23.9	1.5	
		200	8	457	521	343	298.4	269.7	8-φ22	26.9	1.5	
		250	10	533	559	406	362	323.8	12-φ26	28.4	1.5	
		300	12	610	635	483	431.8	381	12-φ26	30.2	1.5	
		350	14	686	762	533	476.2	412.8	12-φ26	33.3	1.5	
		400	16	762	838	597	539.8	469.9	16-φ29	35.1	1.5	
		450	18	864	914	635	577.8	533.4	16-φ32	38.1	1.5	
		500	20	914	991	693	635	584.2	20-φ32	41.1	1.5	
		600	24	1067	1143	813	749.3	692.2	20-φ35	46	1.5	
		650	26	1143	1245	870	806.4	749	24-φ35	66.7	2	
		700	28	1245	1346	925	863.6	800	28-φ35	69.9	2	
		750	30	1295	1397	985	914.4	857	28-φ35	73.1	2	
800	32	1372	1524	1060	977.9	914	28-φ41	79.4	2			
900	36	1524	1727	1170	1085.8	1022	32-φ41	88.9	2			
1000	40	1850	1780	1290	1200.2	1124	36-φ41	88.9	2			
1050	42	2050	1960	1345	1257.3	1194	36-φ41	95.3	2			
1200	48	2180	2100	1510	1422.4	1359	44-φ41	106.4	2			
1400	56	2300	2250	1745	1651	1575	48-φ48	122.3	2			
1500	60	2490	2490	1855	1759	1676	52-φ48	130.2	2			

unit: mm											
Pressure		Bore		Size							
CLASS	Mpa	DN	NPS	L (RF)	L (BW)	D	D1	D2	n-d1	c	f
300	5.0	25	1	165	165	124	88.9	50.8	4-φ19	15.7	1.5
		32	1.25	178	178	133	98.6	63.5	4-φ19	17.5	1.5
		40	1.5	190	190	155	114.3	73	4-φ22	19	1.5
		50	2	216	216	165	127	91.9	8-φ19	20.6	1.5
		65	2.5	241	241	190	149.4	104.6	8-φ22	23.9	1.5
		80	3	283	283	210	168.1	127	8-φ22	26.9	1.5
		100	4	305	305	254	200.2	157.2	8-φ22	30.2	1.5
		125	5	381	381	279	235	185.7	8-φ22	33.3	1.5
		150	6	403	457	318	269.7	215.9	12-φ22	35.1	1.5
		200	8	502	521	381	330.2	269.7	12-φ26	39.6	1.5
		250	10	568	559	444	387.4	323.8	16-φ29	46	1.5
		300	12	648	635	521	450.8	381	16-φ32	49.3	1.5
		350	14	762	762	584	514.4	412.8	20-φ32	52.3	1.5
		400	16	838	838	648	571.5	469.9	20-φ35	55.6	1.5
		450	18	914	914	711	628.6	533.4	24-φ35	58.7	1.5
		500	20	991	991	775	685.8	584.2	24-φ35	62	1.5
		600	24	1143	1143	914	812.8	692.2	24-φ41	68.3	1.5
		650	26	1245	1245	970	876.3	749	28-φ45	77.8	2
		700	28	1346	1346	1035	939.8	800	28-φ45	84.2	2
		750	30	1397	1397	1090	997	857	28-φ48	90.5	2
800	32	1524	1524	1150	1054.1	914	28-φ51	96.9	2		
900	36	1727	1727	1270	1168.4	1022	32-φ54	103.2	2		
1000	40	1850	1780	1240	1155.7	1086	32-φ45	112.8	2		
1050	42	2050	1960	1290	1206.5	1137	32-φ45	117.5	2		
1200	48	2180	2100	1465	1371.6	1302	32-φ51	131.8	2		
1400	56	2300	2250	1710	1600.2	1518	28-φ61	152.4	2		
1500	60	2490	2490	1810	1701.8	1626	32-φ61	162	2		

unit: mm											
Pressure		Bore		Size							
CLASS	Mpa	DN	NPS	L (RF)	L (BW)	D	D1	D2	n-d1	c	f
600	11.0	25	1	216	216	124	88.9	50.8	4-φ19	17.5	6.4
		32	1.25	229	229	133	98.6	63.5	4-φ19	20.6	6.4
		40	1.5	241	241	155	114.3	73	4-φ22	22.4	6.4
		50	2	292	292	165	127	91.9	8-φ19	25.4	6.4
		65	2.5	330	330	190	149.4	104.6	8-φ22	28.4	6.4
		80	3	356	356	210	168.1	127	8-φ22	31.8	6.4
		100	4	432	432	273	215.9	157.2	8-φ26	38.1	6.4
		125	5	508	508	330	266.7	185.7	8-φ29	44.4	6.4
		150	6	559	559	356	292.1	215.9	12-φ29	47.8	6.4
		200	8	660	660	419	349.2	269.7	12-φ32	55.6	6.4
		250	10	787	787	508	431.8	323.8	16-φ35	63.5	6.4
		300	12	838	838	559	489	381	20-φ35	66.5	6.4
		350	14	889	889	603	527	412.8	20-φ39	69.8	6.4
		400	16	991	991	686	603.2	469.9	20-φ41	76.2	6.4
		450	18	1092	1092	743	654	533.4	20-φ45	82.6	6.4
		500	20	1194	1194	813	723.9	584.2	24-φ45	88.9	6.4
		600	24	1397	1397	940	838.2	692.2	24-φ51	101.6	6.4
		700	28	1549	1549	1075	965.2	800	28-φ54	111.2	7
		800	32	1778	1778	1195	1079.5	914	28-φ60	117.5	7
		900	36	2083	2083	1315	1193.8	1022	28-φ67	123.9	7
1000	40	2000	1900	1320	1212.8	1111	32-φ60	158.8	7		
1050	42	2175	2175	1405	1282.7	1168	28-φ67	168.3	7		
1200	48	2400	2180	1595	1460.5	1334	32-φ73	189	7		
1400	56	2710	2385	1855	1695.4	1543	32-φ86	217.5	7		

unit: mm											
Pressure		Bore		Size							
CLASS	Mpa	DN	NPS	L (RF)	L (BW)	D	D1	D2	n-d1	c	f
900	15.0	25	1	254	254	149	101.6	50.8	4-φ26	28.4	6.4
		32	1.25	279	279	159	111.1	63.5	4-φ26	28.4	6.4
		40	1.5	305	305	178	124	73	4-φ29	31.8	6.4
		50	2	368	368	216	165.1	91.9	8-φ26	38.1	6.4
		65	2.5	419	419	244	190.5	104.6	8-φ29	41.1	6.4
		80	3	381	381	241	190.5	127	8-φ26	38.1	6.4
		100	4	457	457	292	235	157.2	8-φ32	44.5	6.4
		125	5	559	559	349	279.4	185.7	8-φ35	50.8	6.4
		150	6	610	610	381	317.5	215.9	12-φ32	55.6	6.4
		200	8	737	737	470	393.7	269.7	12-φ39	63.5	6.4
		250	10	838	838	546	469.9	323.8	16-φ39	69.8	6.4
		300	12	965	965	610	533.4	381	20-φ39	79.2	6.4
		350	14	1029	1029	641	558.8	412.8	20-φ41	85.9	6.4
		400	16	1130	1130	705	616	469.9	20-φ45	88.9	6.4
		450	18	1219	1219	787	685.8	533.4	20-φ51	101.6	6.4
		500	20	1321	1321	857	749.3	584.2	20-φ54	108	6.4
		600	24	1549	1549	1041	901.7	692.2	20-φ67	139.7	6.4
		700	28	1660	1600	1170	1022.4	800	20-φ79	142.9	7
		800	32	2014	1884	1315	1155.7	914	20-φ86	158.8	7
		900	36	2286	1900	1460	1289	1022	20-φ92	171.5	7
1000	40	2180	2100	1510	1339.8	1162	24-φ92	196.9	7		
1200	48	2450	2380	1785	1587.5	1384	24-φ105	233.4	7		
1500	26.0	25	1	254	254	149	101.6	50.8	4-φ26	28.4	6.4
		32	1.25	279	279	159	111.1	63.5	4-φ26	28.4	6.4
		40	1.5	305	305	178	124	73	4-φ29	31.8	6.4
		50	2	368	368	216	165.1	91.9	8-φ26	38.1	6.4
		65	2.5	419	419	244	190.5	104.6	8-φ29	41.1	6.4
		80	3	470	470	267	203.2	127	8-φ32	47.8	6.4
		100	4	546	546	311	241.3	157.2	8-φ35	53.8	6.4
		125	5	673	676	375	292.1	185.7	8-φ41	73.2	6.4
		150	6	705	705	394	317.5	215.9	12-φ39	82.6	6.4
		200	8	832	832	483	393.7	269.7	12-φ45	91.9	6.4
		250	10	991	991	584	482.6	323.8	12-φ51	108	6.4
		300	12	1130	1130	673	571.5	381	16-φ54	124	6.4
		350	14	1257	1257	749	635	412.8	16-φ60	133.4	6.4
		400	16	1384	1384	826	704.8	469.9	16-φ67	146	6.4
		450	18	1537	1537	914	774.7	533.4	16-φ73	162.1	6.4
		500	20	1664	1664	984	831.8	584.2	16-φ79	177.8	6.4
		600	24	2043	2043	1168	990.6	692.2	16-φ92	203.2	6.4
		700	28	2425	2425	—	—	—	—	—	—
		750	30	2812	2812	—	—	—	—	—	—
		800	32	3125	3125	—	—	—	—	—	—
900	36	3445	3445	—	—	—	—	—	—		
2500	42.0	25	1	308	308	160	108	50.8	4-φ26	35	7
		32	1.25	349	349	185	130.2	63.5	4-φ29	38.1	7
		40	1.5	384	384	205	146	73	4-φ32	44.5	7
		50	2	451	451	235	171.4	92.1	8-φ29	50.9	7
		65	2.5	508	508	265	196.8	104.8	8-φ32	57.2	7
		80	3	578	578	305	228.6	127	8-φ35	66.7	7
		100	4	673	673	355	273	157.2	8-φ41	76.2	7
		125	5	794	794	420	323.8	185.7	8-φ48	92.1	7
		150	6	914	914	485	368.3	215.9	8-φ54	108	7
		200	8	1022	1022	550	438.2	269.9	12-φ54	127	7
		250	10	1270	1270	675	539.8	323.8	12-φ67	165.1	7
		300	12	1422	1422	760	619.1	381	12-φ73	184.2	7
		350	14	1692	1692	—	—	—	—	—	—
		400	16	2012	2012	—	—	—	—	—	—
		450	18	2465	2465	—	—	—	—	—	—
		500	20	2895	2895	—	—	—	—	—	—
		600	24	3260	3260	—	—	—	—	—	—

The structure and length of PN16 and PN25 valves are the same as Class 150; The structure and length of PN40 and PN63 valves are the same as Class 300; The structure and length of PN100 valves are the same as Class 600; The structure and length of PN160 valves are the same as Class 900; The dimensions of ball valves with and without springs are the same. If you need O-type wear-resistant ball valves with other structures or lengths, please contact us. We can design and manufacture special valves according to your requirements

Numbering Method C-type Wear-resistant Ball Valve



Unit No.	Meaning	Description of Unit Number	
1	Structural Classification	T-Top-mounted;	
2	Dedicated Functions	D-Low Temperature; G-High Temperature; B-Insulation; T-Regulating; N-With Anti-sulfur Requirements(NACE)	
3	Valve Type	QC-C-type Wear-resistant Ball Valve	
4	Transmission	Handle-ellipsis;3-Worm gear;6-Pneumatic;9-Electric ;8-Gas-hydraulic linkage; 2-Electro-hydraulic linkage	
5	Connection Type	1-Female thread connection; 2-Male thread connection; 4-RF Flange; 6-Butt welding connection; 7-Wafer connection	
6	Sealing Surface Material	Y-Nickel-based Alloy、 Tungsten Carbide、 Chromium Carbide、 STL、 Diamond	
7	Pressure	Nominal pressure (European standard)	10-PN1.0MPa;16-PN1.6MPa;40-PN4.0MPa; 63-PN6.3MPa; 100-PN10.0MPa;160-PN16.0MPa; 250-PN25.0MPa
		Nominal pressure (American standard)	20-PN2.0MPa;50-PN5.0MPa; 110-PN11.0MPa; 150-PN15.0MPa;260-PN26.0MPa;420-PN42.0MPa;
	Level	Pound Class	150LB-Class 150;300LB-Class 300;400LB-Class 400; 600LB-Class 600 900LB-Class 900;1500LB-Class 1500; 2500LB-Class 2500
		JIS K	10K-JIS 10K; 20K-JIS 20K; 30K-JIS30K; 40K-JIS40K
8	Valve Body Material	C-WCB,A105; C5-C5; C6-WC6,F11; C9-WC9,F22; CL-LCB,LF2; LC-LCC; L2-LC2; L3-LC3; P8-CF8,F304; P3-CF3,F304L; R8-CF8M,F316; R3-CF3M,F316L; Ti-T&Titanium Alloy	
9	Internal Material	If the customer does not require it, this code is omitted (carbon steel valve body is equipped with P8 internal parts as standard, and stainless steel valve body is equipped with internal parts consistent with the valve body material)) P8-CF8,F304; P3-CF3,F304L; R8-CF8M,F316 ;R3-CF3M,F316L; F5-Duplex Steel;	

Additional Notes

- 1.If customers have other needs, please contact us.
- 2.It is recommended that you provide the corresponding data sheet when placing an order so that we can manufacture products that fully meet your requirements and serve you better.
- 3.Due to the continuous development of technology, we reserve the right to change the content of the C-type wear-resistant ball valve sample without prior notice to customers.

Quality Service Commitment

- 1、 The products we provide are designed and manufactured according to national standards or corresponding product standards. Each valve is strictly inspected according to the inspection standards before leaving the factory.
- 2、 The products we provide are manufactured, inspected, packaged and shipped strictly in accordance with the relevant provisions of the contract terms, and we ensure that the products are delivered to the designated location on time.
- 3、 Our product warranty period is twelve months. During the warranty period, if the product does not work properly or is damaged due to quality problems, we will be responsible for free repair or replacement.
- 4、 If the customer needs it, we can arrange technical personnel to go to the site to guide installation and commissioning, and provide pre-sales and after-sales technical consultation. The fees will be separately stated by both parties. If the user has any questions, please call us and we will give a reply within 24 hours. If necessary, we will arrive at the site within 48 hours.
- 5、 If users encounter new problems during the using our products, please feel free to feedback so that we can properly handle and improve it to serve you better.



For the working conditions of LNG equipment, We' ve developed ultra-low temperature valves

- 1、 The valve body is a top-mounted integral structure.
- 2、 The extended bonnet design can ensure that the packing is at ambient temperature. The valve stem adopts a blow-out prevention structure.
- 3、 The valve trim is easily disassembled. The valve seat is maintainable and easy to replace. The trim and seal can be quickly removed from the top of the valve for immediate maintenance.